



CSW SERIES - FEATURES

FRACTIONAL HP

GENERAL PURPOSE

NEIMA PREMIUM EFFICIENCY

CRUSHER® DUTY

IEC TRU-METRIC™

PUMP MOTORS

DEFINITE PURPOSE

ADD-ON™ MODIFICATIONS

MOTOR TECHNICAL DATA

DRIVES & SOFT STARTERS

CONTROLS

No.	DESCRIPTION
1	Double Pushbutton
2	Protection Cover for Double Pushbutton
3	Illuminated Flush Pushbutton
4	Flush Pushbutton
5	Protection Cover for Flush Pushbutton
6	Selector Switch – Knob
7	Selector Switch – Lever
8	Illuminated Selector Switch
9	Key Switch
10	Pilot Light
11	Mushroom Pushbutton
12	Emergency-Stop Pushbutton – Twist Release
13	Emergency-Stop Pushbutton – Key Release
14	Plate Holder
15	Legend Plate
16	Double Contact Block 1NO/1NC or 2NO
17	LED Block
18	Contact Block – NO or NC
19	Contact Block – NCdb (delayed break)
20	Push-on/Push-off Block
21	Contact Block – NOem (early make)
22	Flange – 3 positions
23	Flange – 5 positions
24	Illuminated Extended Pushbutton
25	Illuminated Mushroom Pushbutton

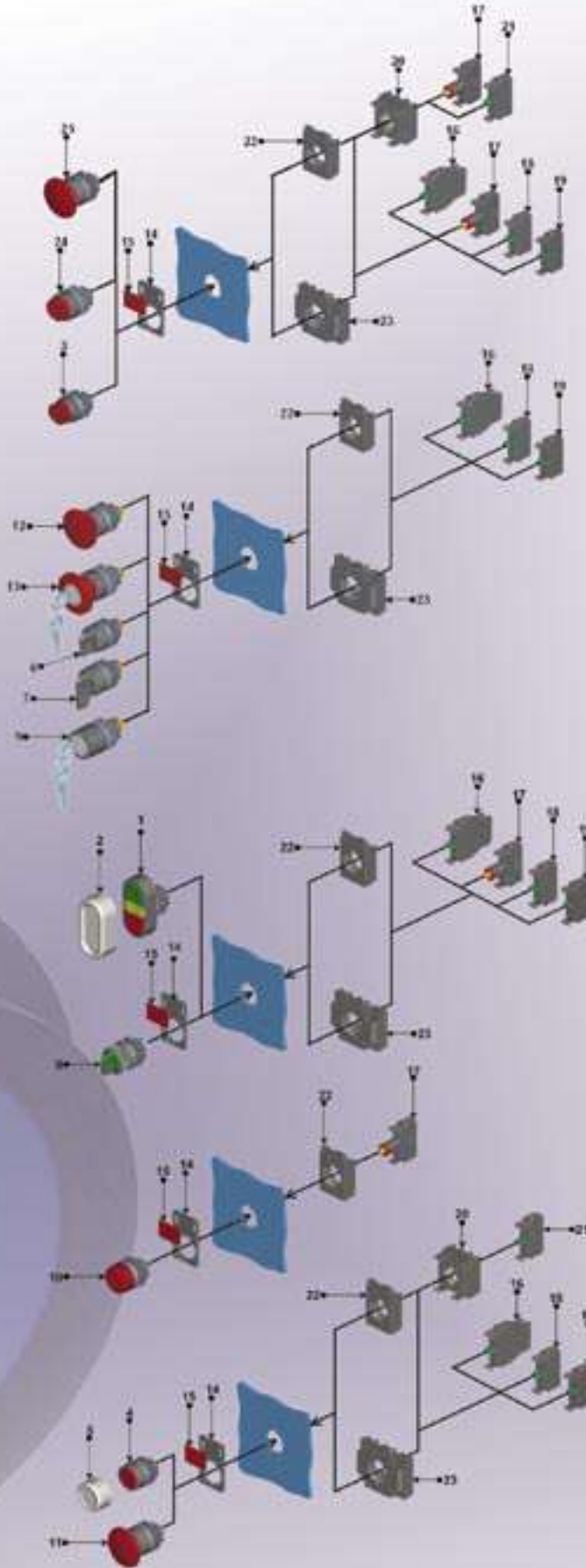

APPROVALS





WEG has used its leading-edge technology & development capability to design CSW series line of pushbuttons, pilot lights, selector switches and accessories. These user friendly and durable Ø22mm pilot devices allow their use in several industrial applications and environments.

BIDL – LED Blocks

Aiming in providing high luminosity to the illuminated devices, WEG has developed an innovative BIDL blocks, with integrated super-bright LEDs. They are available in the voltages of 12Vac/dc, 24Vac/dc, 48Vac/dc, 110-130Vac, 125Vdc and 220-240Vac and in the colors red, green, yellow, white and blue, easily identified in the LED holder.



Besides the high luminosity, the BIDL blocks have many other interesting characteristics, such as:

- Long life expectancy
- Great performance on shock and vibration applications
- Extremely low power consumption and thermal dissipation
- High luminosity and color definition (independent of the lens)

FAST AND EASY ASSEMBLING SYSTEM

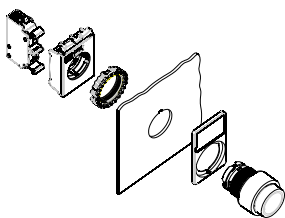

The Mounting of the contact blocks to the operator (pushbutton, selector switch or indicator) is done through a snap-on flange which ensures a fast and tight fitting. This system allows its removal in a practical and fast way, without tools. Each single block can be mounted or removed individually: to assemble, just snap the components together and a common screwdriver is all that is necessary for the disassembly. The ergonomic design of the new locking ring allows hand tightening, without the need for a screwdriver.

CONTACT BLOCKS - SAFETY AND RELIABILITY

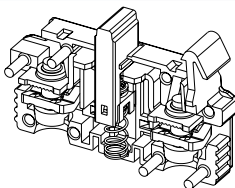

High efficiency self-cleaning contact bridges; Pure Silver Contacts (Ag100), ensure in every condition maximum reliability and to monitor control circuits at low energy levels (5mA/12V). NC Contacts with "Positive Break" system, ensures the circuit interruption.

ACCESSORIES



A complete line of accessories is available, including legend plates, protection covers, lenses for pilot lights, solid and engraved caps for flush pushbuttons.

FRACTIONAL HP

GENERAL PURPOSE

NEMA PREMIUM EFFICIENCY

CRUSHER® DUTY

IEC TRU-METRIC™

PUMP MOTORS

DEFINITE PURPOSE

ADD-ON™ MODIFICATIONS

MOTOR TECHNICAL DATA

DRIVES & SOFT STARTERS

CONTROLS